

Data sheet

OpDAT REGplus for 6xSC-D, unequipped, 1xM20, with crimp splice holder

Page 1/4

P/N
15024000010E
EAN 4250184117872

2017-06-02

Illustrations



Dimensional drawing

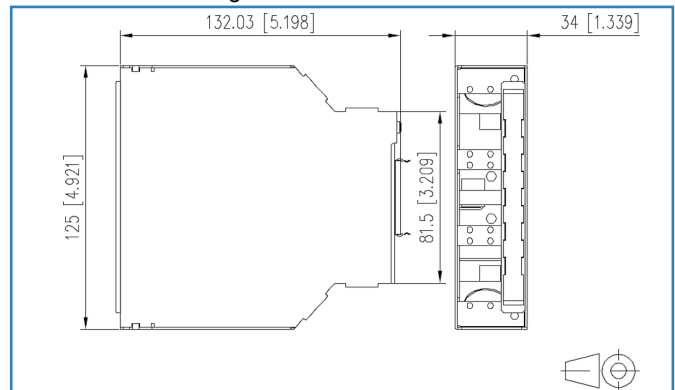

See enlarged drawings at the end of document

Product specification

- splice distributor for TH35 rail
- unequipped
- with fiber reservoir
- custom-labeled identification strips
- various mounting versions on rail
- splice tray with crimp splice holder for up to 12 splices / front plate can be completely removed
- cable feed from top or bottom, straight or inclined, with M20 cable gland (up to 2 possible)
- width: 34 mm (2HP), height: 125 mm, depth: 132.5 mm (from rail, without couplers)
- can be equipped with SC-D couplers
- feed of preassembled cables is possible
- one cable gland M20 with strain relief included in the delivery
- housing cover fastening by means of just one captive screw
- unoccupied coupler recesses can be closed with special blank covers
- blank cover 1x (860088-01), 2x (860088-02)
- variants: with crimp splice holder, with shrink splice holder
- please note: if you use preassembled cables with ST plugs, use the unequipped version of the OpDAT REG plus. The ST-D couplers required in this case are available as accessory. Before mounting the couplers in the housing, plug the preassembled ST plugs in the couplers for reasons of space.

OpDAT REGplus for 6xSC-D, unequipped, 1xM20, with crimp splice holder

P/N
15024000010E
EAN 4250184117872

2017-06-02

Technical Data

General Data

Fields of application	Harsh environment
Design	patch panel
Color	gray
Dimensions	
Dimension (L x W x H)	132.03 x 125.00 x 34.00 mm
Dimension (L x W x H)	5.198 x 4.921 x 1.339 in.
Horizontal pitch	2HP
Labeling option	identification label

Connections/interfaces

Cable access/outlet	from top or bottom, straight or inclined
---------------------	--

Mechanical characteristics

Strain relief	PG gland
---------------	----------

Materials and material properties

Material - Housing	Frianyl
Material - Cover	Frianyl
Material - Strain relief	PA 6.6 UL94 V0
Material - Standard rail mounting support	Al (Aluminium)

Approvals

RoHS	compliant
------	-----------

Classifications

ETIM 5.0	EC001130
ETIM 6.0	EC001130

Packing details

Type of packaging	1 pc(s) / box
Packaging unit - Weight (gram)	606.00 g
Packaging unit - Weight (pound)	1.34 lb
Packaging dimension (W x H x D)	145.00 x 182.00 x 40.00 mm
Packaging dimension (W x H x D)	5.709 x 7.165 x 1.575 in.

OpDAT REGplus for 6xSC-D, unequipped, 1xM20, with crimp splice holder

P/N
15024000010E
EAN 4250184117872

2017-06-02

Accessories

P/N	Designation
15090051-I	OpDAT ST-D adapter MM (ceramic, metallike)
15090052-I	OpDAT SC-D adapter MM (ceramic, metallike)
15090053-I	OpDAT ST-D/SC-D adapter MM (ceramic, metallike)
899789-01	Label sheet for E-DAT C6 and E-DAT design patch panels
15090071-I	OpDAT LC-Q adapter SM (ceramic, blue)
150900C2-I	OpDAT SC-D adapter MM (Ph-Br, metallike)
150900D2-I	OpDAT SC-D adapter SM (ceramic, metallike)
15090041-I	OpDAT ST-D adapter MM (Ph-Br, metallike)
150900C3-I	OpDAT SC-D/ST-D adapter MM (Ph-Br, metallike)
15090072-I	OpDAT LC-Q adapter MM (Ph-Br, beige)
150900D3-I	OpDAT ST-D/SC-D adapter SM (ceramic, metallike)
1509007A-I	OpDAT LC-Q APC adapter SM (ceramic, green)
15090078-I	OpDAT LC-Q adapter MM (ceramic, aqua)
15090079-I	OpDAT LC-Q adapter MM (ceramic, heather violet)
150900BA-I	OpDAT SC-D adapter MM (ceramic, aqua)
150900BB-I	OpDAT SC-D adapter MM (ceramic, heather violet)
150900B2-I	OpDAT SC-D adapter MM (ceramic, beige)
150900E2-I	OpDAT SC-D adapter SM (ceramic, blue)
150900F2-I	OpDAT SC-D APC adapter SM (ceramic, green)
150900D4-I	OpDAT SC-D APC adapter SM (ceramic, metallike/green)
15090052-30	OpDAT SC-D adapter MM (ceramic, metallike) - 30 pieces
15090071-30	OpDAT LC-Q adapter SM (ceramic, blue) - 30 pieces
15090078-30	OpDAT LC-Q adapter MM (ceramic, aqua) - 30 pieces
15090079-30	OpDAT LC-Q adapter MM (ceramic, heather violet) - 30 pieces
1509007A-30	OpDAT LC-Q APC adapter SM (ceramic, green) - 30 pieces
150900B2-30	OpDAT SC-D Kupplung MM (Keramik, beige) - 30 Stück
150900BA-30	OpDAT SC-D adapter MM (ceramic, aqua) - 30 pieces
150900BB-30	OpDAT SC-D adapter MM (ceramic, heather violet) - 30 pieces
150900D2-30	OpDAT SC-D adapter SM (ceramic, metallike) - 30 pieces
150900D3-30	OpDAT ST-D/SC-D adapter SM (ceramic, metallike) - 30 pieces
150900D4-30	OpDAT SC-D APC adapter SM (ceramic, metallike/green)- 30 pieces
150900E2-30	OpDAT SC-D coupler SM (ceramic, blue) - 30 pieces
150900F2-30	OpDAT SC-D APC adapter SM (ceramic, green) - 30 pieces

Data sheet

Page 4/4

**OpDAT REGplus for 6xSC-D, unequipped,
1xM20, with crimp splice holder**

P/N
15024000010E
EAN 4250184117872

2017-06-02

Illustrations

Dimensional drawing

