

## Data sheet

### OpDAT Industry SC-RJ/2SC MM adapter insert

Page 1/4

P/N

1402100820MI

EAN 4250184114284

2017-30-05

## Illustrations



Dimensional drawing

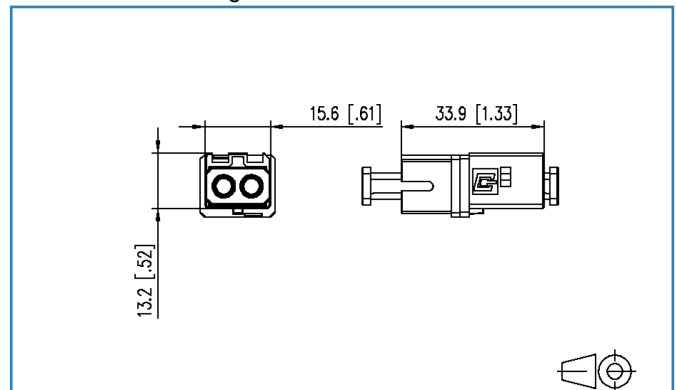

See enlarged drawings at the end of document

## Product specification

- SC-RJ/2SC adapter
- slotted ceramics sleeve for single mode applications
- slotted metal sleeve (Ph-Br) for multi mode applications
- conformity with relevant IEC framework specifications with regard to testing conditions and connector compatibility unilaterally to connector version SC to IEC 61754-4, IEC 60874-14 and SC-RJ to IEC 61745-24, EN 50377-6-1
- compliance with EN 50173-1:2011-09 and ISO/IEC 24702 with regard to limit values for insertion loss
- flame-retardant and halogen-free plastic housing
- flame-retardant and halogen-free dust cover
- in flange or wall outlet of var. 1 and 4 - suitable for integration
- variant 14 only available in sets
- Service life: min. 500 plug-in cycles
- operating temperature -40°C to +70°C
- variants: blue (SM), beige (MM)

### Technical Data

#### General Data

Design	Adapter
Transmission technology	Fiber optic
Color	beige
Dimensions	
Dimension (L x W x H)	33.90 x 15.60 x 13.20 mm
Dimension (L x W x H)	1.335 x 0.614 x 0.52 in.
Mode type of the fiber	Multimode
Labeling option	on housing

#### Connections/interfaces

Connector technology interface 1	SC-RJ/2SC
Connector technology interface 2	SC-RJ/2SC
Number of ports interface 1	1
Number of ports interface 2	1
Number of equipped ports interface 1	1
Number of ports interface 2 equipped	1
Number of ports with dust protection interface 1	1
Number of ports with dust protection interface 2	1

#### Electrical characteristics

Insertion loss	max. 0.4 dB
Return loss	min. 30 dB

#### Mechanical characteristics

Cut-out	SC, LC-D, E2000
Mounting method	snap-in function
Insertion and withdrawal force	max. 30 N
Life - Number of mating cycles	min. 500

#### Materials and material properties

Material - Housing	PBT 20% GF
Material - Sleeve	PhBr, slotted
Material - Dust protection	TPE UL-rated
Material - Duplex clip	PBT 20%GF

### Technical Data

#### Environmental conditions

Temperature (min. - max.)

Temperature - Storage °C -40 - 70 °C

Temperature - Storage °F -40 - 158 °F

Temperature - Operating °C -40 - 70 °C

Temperature - Operating °F -40 - 158 °F

#### Approvals

RoHS compliant

#### The product meets the following standards

Generic cabling systems

General requirements DIN EN 50173-1:2011-09

Industrial area ISO/IEC 24702 AMD 1 | DIN EN 50173-3: 2011-09  
TIA/EIA 1005

#### Classifications

ETIM 5.0 EC000752

ETIM 6.0 EC000752

#### Packing details

Type of packaging 10 pc(s) / box

Packaging unit - Weight (gram) 117.00 g

Packaging unit - Weight (pound) 0.26 lb

Packaging dimension (D x W x H) 89.00 x 250.00 x 105.00 mm

Packaging dimension (D x W x H) 3.504 x 9.843 x 4.134 in.



Data sheet

Page 4/4

**OpDAT Industry SC-RJ/2SC MM adapter insert**

P/N

1402100820MI

EAN 4250184114284

2017-30-05

**Illustrations**

Dimensional drawing

