

# Notes on the protection of patch cables

The MCO IP69k protective housing for outdoor applications can be used to protect numerous interfaces as well as patch cable connections. Since RJ45 plugs cannot be passed

through the seals included in the scope of delivery due to their dimensions, a remedy must be found.

To ensure IP69k protection, it is recommended to disconnect one side of the patch cable.

To be able to maintain the IP69k protection, ideally one plug side of the patch cable should be disconnected and replaced by a field-terminable plug, such as our C6<sub>A</sub> RJ45 field plug pro

(130E405032-E), so that the installation can then be carried out according to the installation instructions.

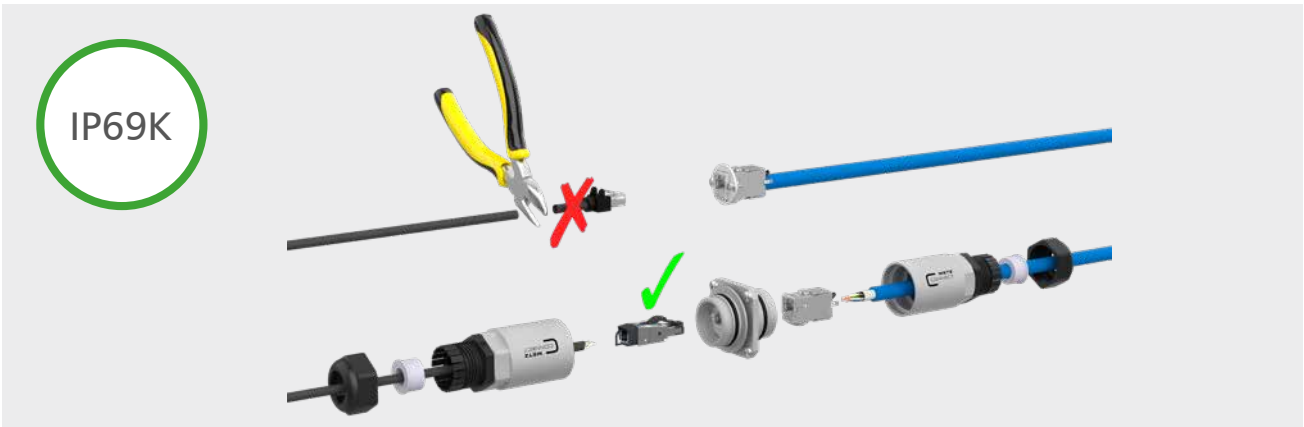

The use of the split seal reduces the degree of protection to IP66 from IP69k.

Alternatively, we offer a split seal for patch cables (895154-I), which can be widened accordingly to allow the RJ45 connector to pass through. Consequently, patch cable connections can be protected without having to disconnect the connected

RJ45 plug first. However, it is important to note that the use of the split seal for patch cables (895154-I) reduces the protection class from IP69k to IP66, which is why we only recommend this alternative option to a limited extent.



Furthermore, it should be taken into account that only cables suitable for outdoor installation may be used in outdoor areas, such as our patch cable RJ45 6kV Flex500 Outdoor AWG 24 (13084F3000-E).